



Analogue Meters SQ0x01 series

Phase Sequence Indicator - SQ0201 & SQ0301



- o Indicates phase sequence
- o Indicates phase fault
- o Good read-out on larger distance
- o Protective cover for terminals



PROPERTIES

- o Indicates phase sequence
- o Indicates phase fault
- o Good read-out on larger distance
- o Protective cover for terminals

APPLICATION

Phase Sequence Indicators show installers and service people the correct way to make three-phase connections. When correctly connected, top lamp glows. A reversed sequence lights the bottom lamp. An open phase lights both lamps at 200 volts.

CONSTRUCTION

The instrument operates with a simple circuit that compares phase shifts on all three phases, if sequence is OK the corresponding lamp is lit.

TECHNICAL DATA

DESIGN:

Material of housing: PC
unflammable, according to **UL 94 V-0**
Enclosure protection: Case IP 52, terminal contacts IP 00
(IP 20 for connection terminals)
according to **EN 60529**
Operating position: Vertical
Installation category (Vrms): CAT III 600 V
(FQ0407 CAT II 600 V/ III 300 V)
Consumption: < 2 VA

AMBIENT CONDITIONS

Climatic conditions:

JVF (DIN 40 040)

Standards **EN 60051-1**
EN 60051-2
EN 60051-9

Temperature:

Reference range of operation +18 ... +28°C

Nominal range of operation -25 ... +55°C

Storing -40 ... +70°C

Humidity up to 80% (without condensing)

MEASURING RANGE:

Nominal voltage: 200 -500V

Nominal frequency: 50-60Hz or 400Hz

DIMENSIONAL DRAWING

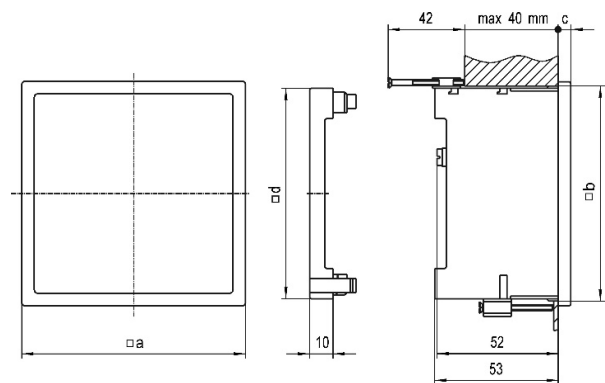

Picture 1: Dimensional drawing SQ0201 and SQ0301 (all dimensions are in mm)

Type		SQ0201	SQ0301
Bezel (mm)	□ a	96	72
Panel cut-out (mm)	□ b	92 ^{+0.8}	68 ^{+0.8}
Bezel height (mm)	c	5.5	5.5
Protect cover (mm)	□ d	90	66.5
Scales length (mm)		92	62
Weight approx. (kg)		0.18	0.15

Table 1: Dimensions and weight

DATA FOR ORDERING

- ☐ Instrument size,
- ☐ Frequency range.

ORDERING EXAMPLE FOR STANDARD VERSION:

- ☐ SQ0201 50-60Hz
- ☐ SQ0301 400Hz